



SERIES CRUX 1

DESCRIPTION

Crux 1 is the wall cabinet of the barpa range of cabinets. It's available in a range of heights and depths and accommodates a load of up to 60 kg. The best way to get the most of this cabinet is with barpa accessories, you should get them separately. Order this product either assembled or in flat packs.



SPECIFICATIONS

Standard	ANSI/EIA RS-310-D; IEC60297-2; DIN41494 Part 1 and 7
Material	SPCC Cold Rolled Steel; Mounting profile: 1.2mm; Others 1.0mm
Loading Capacity (kg)	60
Color	Black (RAL9004)
Earth connection	Yes
Product Family	Series Crux

FEATURES

Flat packing, mounting time less than 5 minutes
Cable entry on both of top cover and bottom panel
Steel front door, opening direction of door can be changed, turning angle of front door is over 180 degrees
Glass front door
Wall mounted panel, convenience for installation, locked from inside with screw, avoiding to be stolen or accidentally dropped
Flat side panel, easy installation
19" standard installation with pre-installation of ventilation

ORDER INFORMATION

Code	U	Width (mm)	Length (mm)	Height (mm)	Dimensions (mm)		Weight (kg)	
					Pack 1	Pack 1		
82321060604	6	570	450	370	420x620x230	17		
82321060606		570	600	370	570x620x250	20		
82321090604	9	570	450	500	560x620x210	20		
82321090606		570	600	500	570x620x230	23		
82321120604	12	570	450	635	690x620x190	24		
82321120606		570	600	635	690x630x180	27		
82321150604	15	570	450	770	820x620x180	28		
82321150606		570	600	770	840x610x180	31		
82321180604	18	570	450	900	960x620x180	31		
82321180606		570	600	900	950x620x180	41		
82321220604	22	570	450	1080	1130x620x180	36		
82321220606		570	600	1080	1140x620x180	41		

Note: To order the assembled rack, add "M" at the end of the code.

PACKAGING INFORMATION

Pack	Description	Quantity
1	Back Frame	1
	Side Frame	2
	Top Cover	1
	Bottom	1
	Front Frame	1
	Front Door	1
	Side Panel	2
	Mounting Rail	4
	Screw and Nuts	10units (6U-12U) 20units (15U-27U)
	Tools	1pc Spanner
	Instructions Manual	1

TECHNICAL DRAWING (mm)

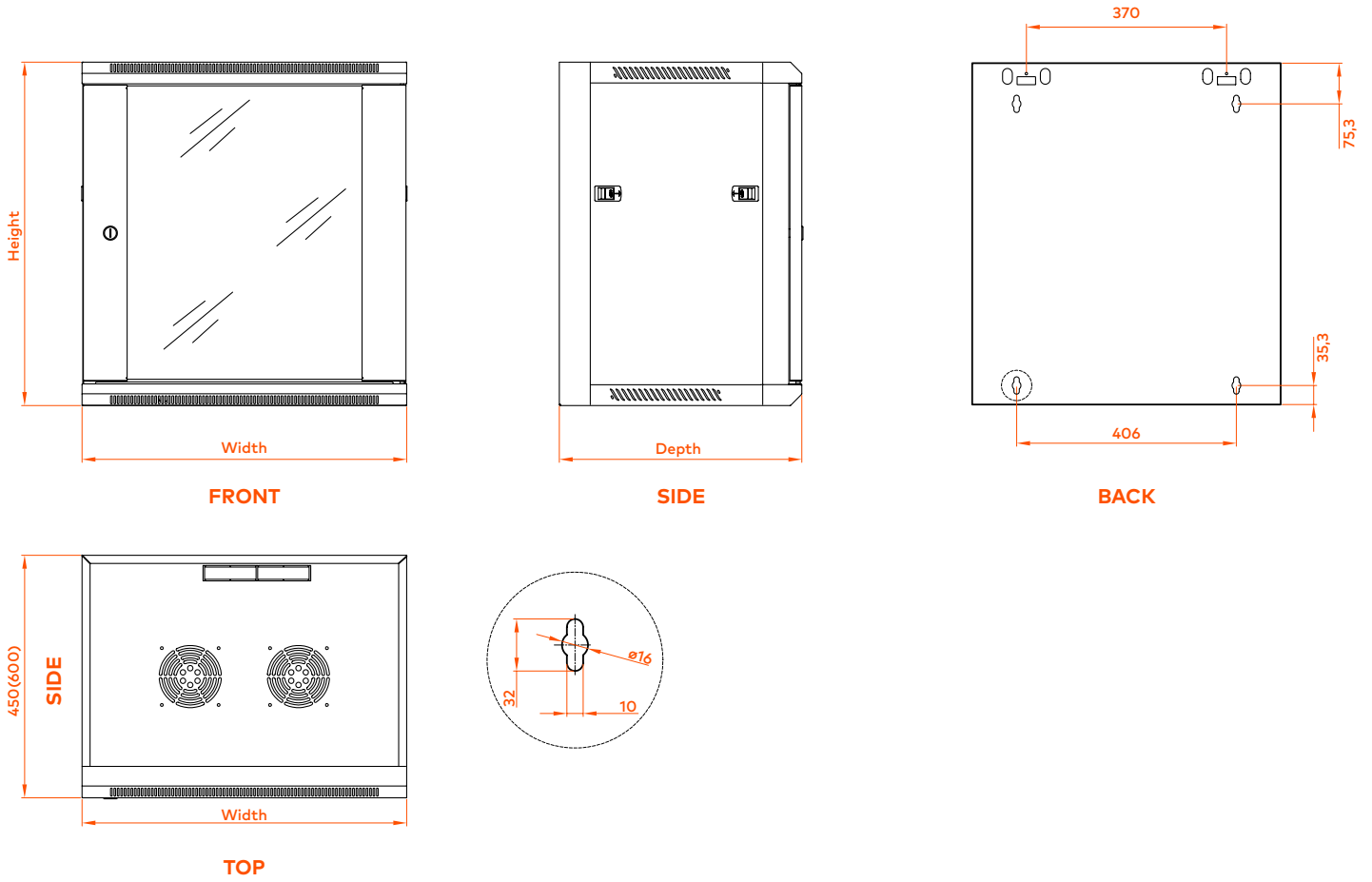

PACKAGING

This images are merely illustratives. We want you to see the importance we attach to the packaging.
We always work with products and materials that are easy to use.



To order the assembled rack, add "M" at the end of the code.
Please specify in your request.



As part of our goal to achieve quality excellence, our barpa System Warranty can give you 25 years products and solution assurance of compliance with the industry performance standard comparing with the class installed. This warranty applies to network infrastructure installations that was made by an approved barpa partner using an barpa solution (end-to-end). For more informations go to our website.