



---

**INDUS**  
DATASHEET  
WALL VERSION

# INDUS 19" WALL MOUNTING CABINET INDOOR - IP55



## PRODUCT DESCRIPTION

- The series Indus of barpa are designed for industrial purposes. Cabinet mounted with IP55 protection class against dust and water jets (EN60529).

### FEATURES

Gasketed door

Door open until 140 degrees

Epoxy polyester type powder coating which is RAL 7035 Light Grey color

Welded Frame

Possible to install fans or ventilation of barpa

### APPLICATIONS

Warehouses, factories, where they are harsh environments but with no direct rain or external usage.

### SPECIFICATIONS

Standard	IEC 60529:1989+A1:1999+A2:2013; ANSI/EIA RS-310-E; IEC 60297-3; DIN41494 Part 1 and 7
Loading Capacity (kg)	100
Color	Grey (RAL7035)
Earth connection	Yes
Index Protection	IP55
IK	10

### RECOMMENDATIONS

Do not change the construction or design of the cabinet

Load the weight equally

Do not damage the cabinet mechanically

Do not install in outdoor

Do not install next to places with danger of explosion

Do not overload

## INDUS 19" WALL MOUNTING CABINET INDOOR - IP55



### ROBUST CONSTRUCTION

barpa has a robust and welded construction. High quality processing and the newest technologies ensure a perfect look of the cabinet.



### FLEXIBLE DOOR OPENING

The hinge system allows the door to open until 140°.



### HANDLES

We manufacture the handles to be easy and safe to use, with 2 point locking system.



### GASKETED DOOR

With gasketed door helps prevent dust and water jets getting inside.

## INDUS 19" WALL MOUNTING CABINET INDOOR - IP55



### LOAD CAPACITY

100kg load capacity, allow you to use the cabinet with no worries of weight.



### TOP VIEW

You have the possibility to install ventilation in the top of the cabinet.



### EARTH GROUND

Cabinet ready for earth ground connection.



### ADJUSTABLE VERTICAL RAILS

Vertical 19" rails can be adjusted freely in depth of the cabinet.

## INDUS 19" WALL MOUNTING CABINET INDOOR - IP55



### WATER CONDENSATION

You find in the bottom of the cabinet holes to remove the water condensation.

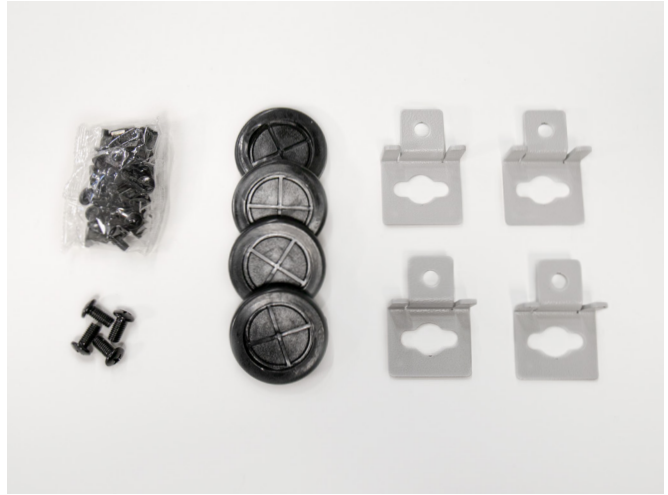

### ACCESSORIES

Accessories included.

### ACCESSORIES INCLUDED

10 cage nut (20pcs for 18U)

10 cross recessed pan head screws (20pcs for 18U)

4 Cross black rubber ring

4 pieces to mount in wall

TECHNICAL DRAWING (mm)

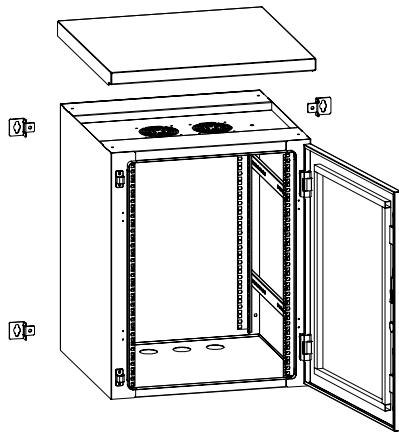
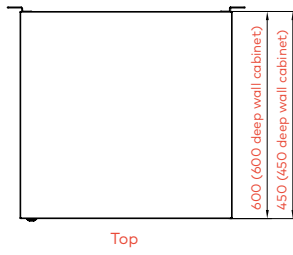
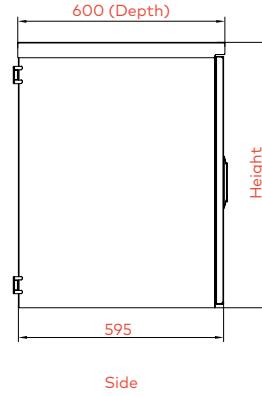
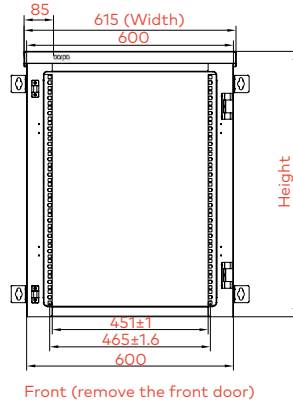
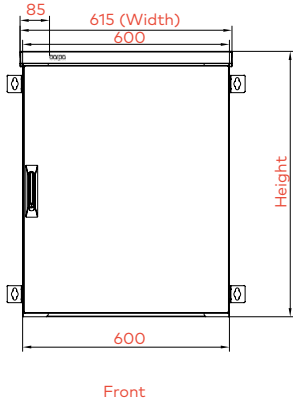
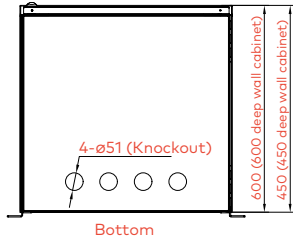

## PACKAGING



## ORDER INFORMATION

Code	U	Width (mm)	Depth (mm)	Height Mounted (mm)	Weight (kg)	EAN
82323120604	12	600	450	635	31,5	5608445032478
82323120606	12	600	600	635	37,0	5608445032485
82323180604	18	600	450	902	37,5	5608445032492
82323180606	18	600	600	902	45,0	5608445032508